

AMERICAN DELUXE FAT STRATOCASTER 0101100 / 1102

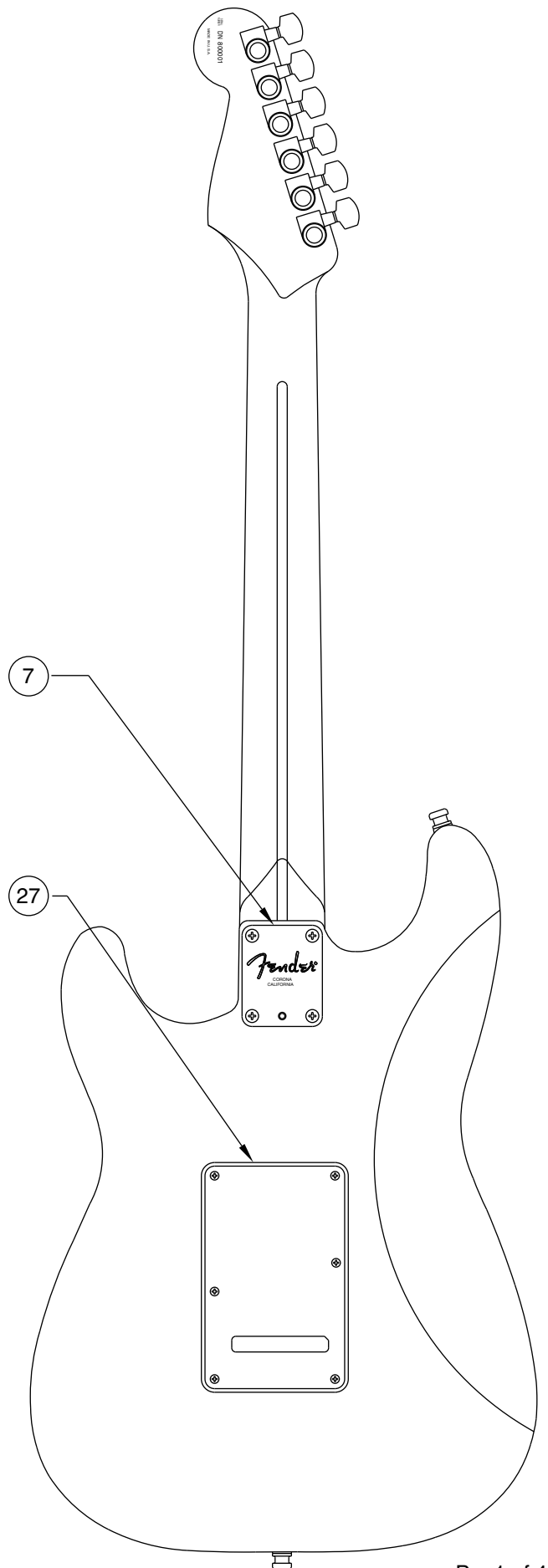

PICKGUARD ASSEMBLY

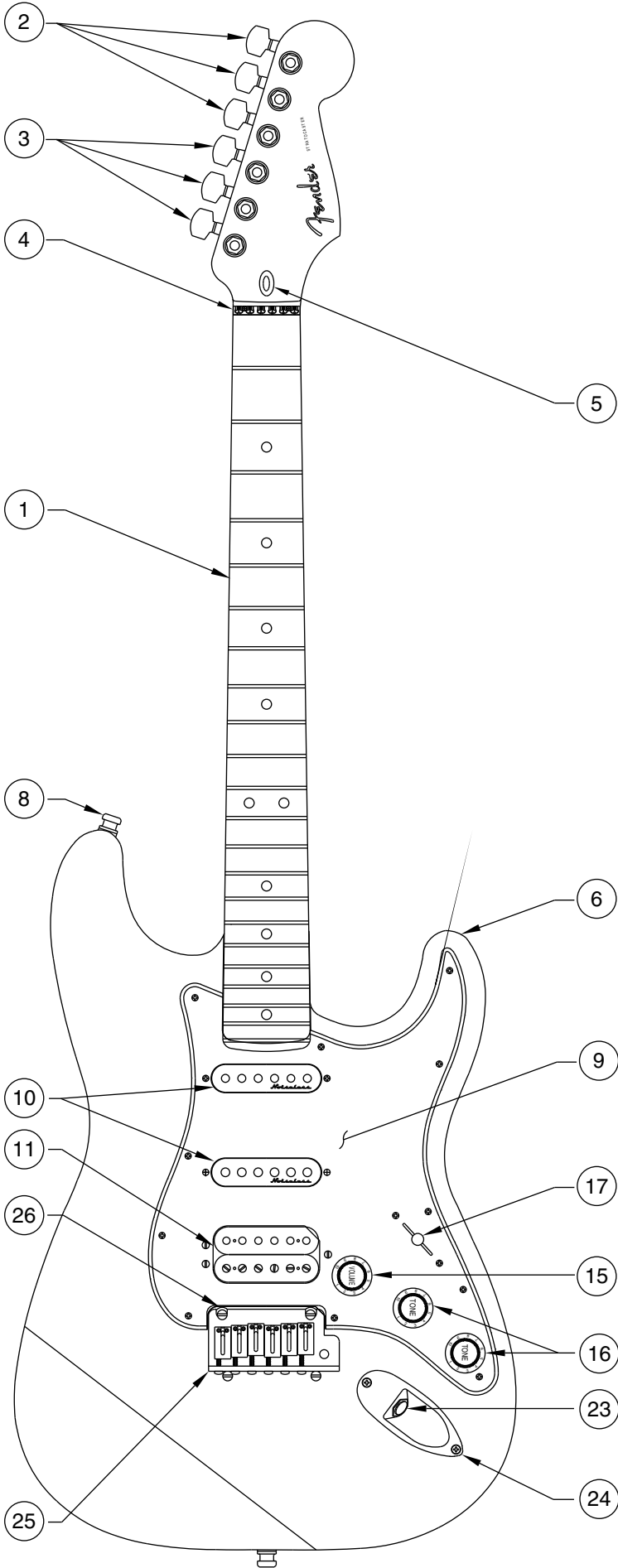
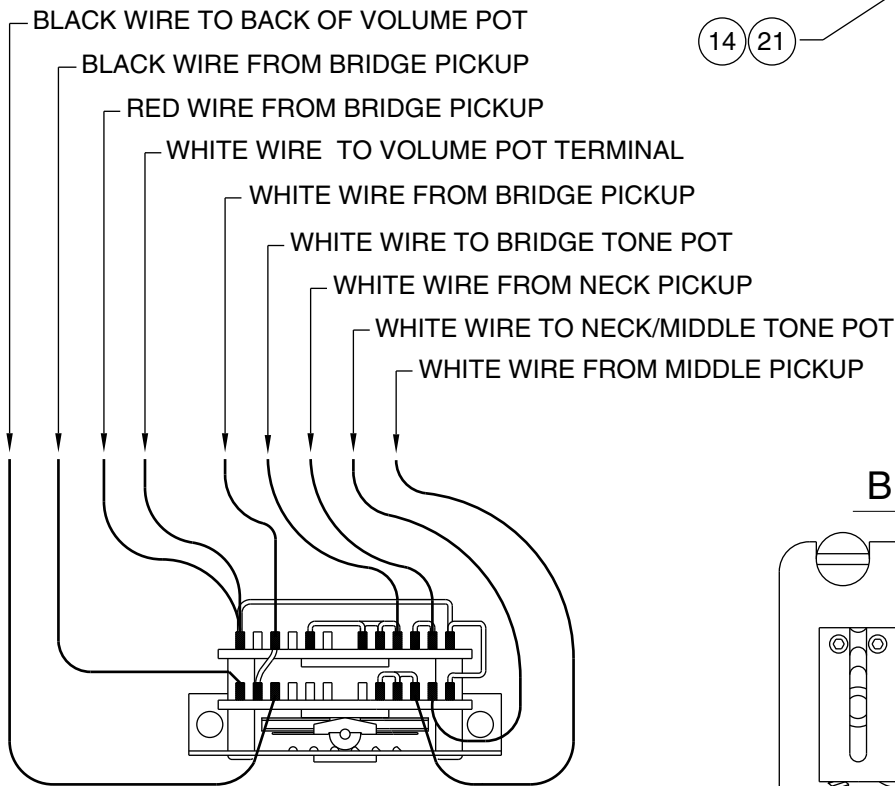
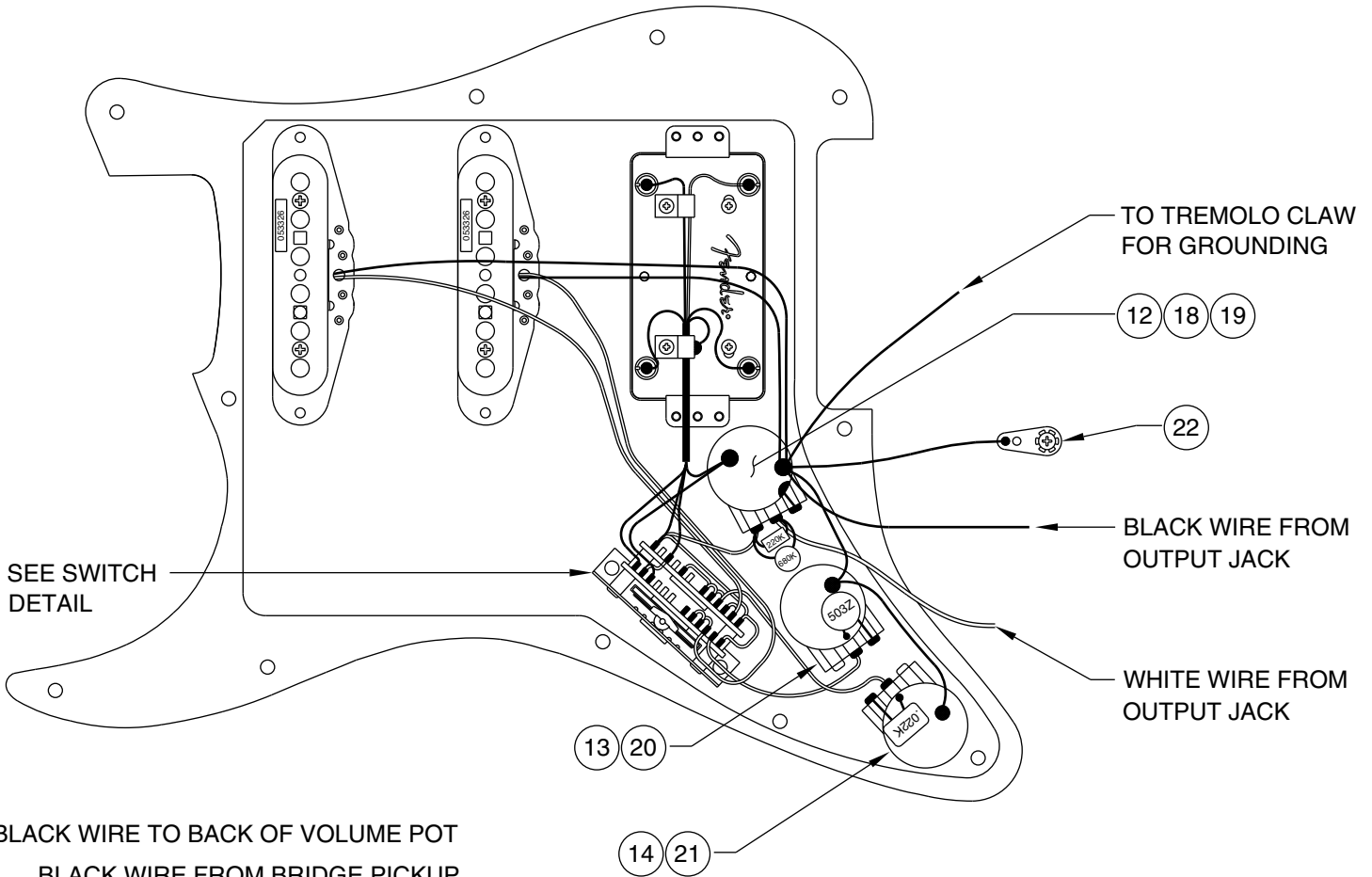

SWITCH WIRING DETAIL

BRIDGE ASSEMBLY

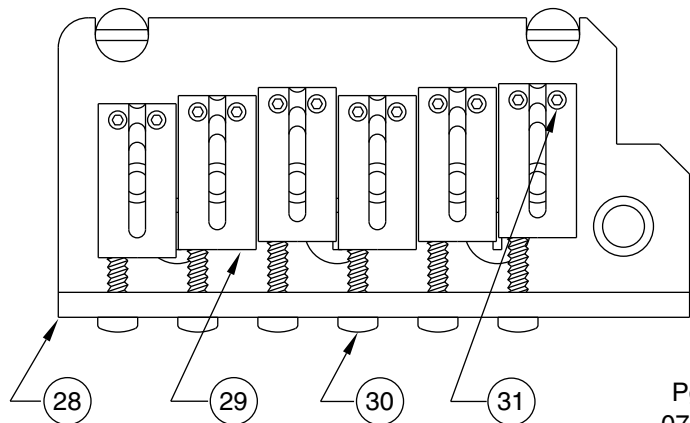

AMERICAN DELUXE FAT STRATOCASTER 0101100 / 1102

| REF.# | P/N | DESCRIPTION | REF.# | P/N | DESCRIPTION |
|-------|------------|--|-------|------------|---------------------------------|
| 1 | 0054018000 | Neck, American Deluxe Fat Stratocaster, R/W | | 0019656000 | Mounting Screw |
| | 0054019000 | Neck, American Deluxe Fat Stratocaster, M/N | | 0010272100 | Claw, Tremolo |
| 2 | 0036447000 | Tuning Key, (1) Set, Locking | | 0015636000 | Mounting Screw |
| 3 | 0036448000 | Tuning Key, (1) Set, Locking,(4,5&6) | 26 | 0028957000 | Pivot Screw |
| 4 | 0041615000 | Roller Nut | | 0028958000 | Insert |
| | 0041613000 | Shim, .005 | 27 | 0054029000 | Back Plate, Tremolo, Aged |
| | 0041612000 | Shim, .010 | | 0049683000 | Back Plate, Tremolo, Shell |
| | 0041611000 | Mounting Screw | | 0021407000 | Mounting Screw |
| 5 | 0020810000 | Truss Rod Adjustment Nut | 28 | 0036527000 | Bridge Plate |
| | 0023811000 | Truss Rod Adjusting Wrench | 29 | 0036528000 | Bridge Section, (6) |
| 6 | 0054014xxx | Body, American Deluxe Stratocaster, Alder | 30 | 0017031000 | Intonation Screw, (6) |
| | 0054015xxx | Body, American Deluxe Stratocaster, Solid Ash | | 0019395000 | Intonation Spring, 5&6 |
| 7 | 0054038000 | Neck Mounting Plate | | 0019394000 | Intonation Spring, 1-4 |
| | 0021424000 | Mounting Screw | 31 | 0026779000 | Height Adjustment Screw, 1&6 |
| | 0031571000 | Tilt Adjustment Screw | | 0026780000 | Height Adjustment Screw, 2-5 |
| | 0023811000 | Tilt Adjusting Wrench | | 0018531000 | Adjusting Wrench, Saddle Height |
| 8 | 0021453000 | Strap Button | | | |
| | 0021422000 | Mounting Screw | | | |
| | 0019056000 | Felt Washer, Black | | | |
| | 0020491000 | Felt Washer, White | | | |
| 9 | 0054021000 | Pickguard, Am. Deluxe Fat Strat., Mint Green | | | |
| | 0054022000 | Pickguard, Am. Deluxe Fat Strat., Brown Shell | | | |
| | 0021407000 | Mounting Screw | | | |
| 10 | 0054122000 | Pickup, Neck/Middle, Humbucker, Hot Rod | | | |
| | 0048631000 | Mounting Screw | | | |
| | 0055172000 | Tubing, Latex Cut | | | |
| 11 | 0054036000 | Pickup, Bridge, Noise Free, Am. Dlx. Fat Strat | | | |
| | 0050166000 | Mounting Screw | | | |
| | 0050167000 | Spring, Humbucker | | | |
| 12 | 0056244000 | Control, 500K, A-Taper | | | |
| | 0016352000 | Mounting Hex Nut | | | |
| | 0022384000 | Lock Washer, Intl | | | |
| 13 | 0054032000 | Control, 1 Meg, A-Taper, Split Shaft | | | |
| | 0016352000 | Mounting Hex Nut | | | |
| | 0022384000 | LockWasher, Intl | | | |
| 14 | 0054028000 | Control, 1Meg, A-Taper, No Load | | | |
| | 0016352000 | Mounting Hex Nut | | | |
| | 0022384000 | Lock Washer, Intl | | | |
| 15 | 0056145000 | Knob, Volume, White | | | |
| 16 | 0056144000 | Knob, Tone, White, (2) | | | |
| 17 | 0050610000 | Switch, Lever 5-Position | | | |
| | 0021417000 | Mounting Screw | | | |
| | 0053765000 | Knob, White | | | |
| 18 | 0011435002 | Capacitor, .680pf | | | |
| 19 | 0025059001 | Resistor, 220K | | | |
| 20 | 0015552000 | Capacitor, .05uf | | | |
| 21 | 0024832000 | Capacitor, .022uf | | | |
| 22 | 0012869000 | Solder Lug | | | |
| | 0015116000 | Mounting Screw | | | |
| 23 | 0021956000 | Output Jack | | | |
| | 0016352000 | Mounting Hex Nut | | | |
| | 0016436000 | Lock Washer, Intl | | | |
| 24 | 0010280090 | Ferrule, Jack | | | |
| | 0021407000 | Mounting Screw | | | |
| 25 | 0036449000 | Bridge Assembly, Ultra Strat | | | |
| | 0036534000 | Arm, Tremolo | | | |
| | 0018671000 | Spring, Tremolo | | | |
| | 0036530000 | Block, Tremolo | | | |

| Body Part Number | |
|------------------|------------------------|
| 0054014500 | 3 Color Sunburst |
| 0054014506 | Black |
| 0054014538 | Crimson Transparent |
| 0054015501 | White Blonde |
| 0054015521 | Natural |
| 0054015548 | Teal Green Transparent |

SWITCH & CONTROL FUNCTION

| 5 WAY SWITCH POSITION | | | | | |
|-----------------------|----------------|----|----|----|-------------------------|
| | | | | | ← 5 WAY SWITCH POSITION |
| T1 | T2 | T2 | T2 | T2 | ← TONE CONTROL |
| | | | | | ← NECK PICKUP |
| | | | | | ← MIDDLE PICKUP |
| | | | | | ← BRIDGE PICKUP (A) |
| | | | | | ← BRIDGE PICKUP (B) |
| | ← PICKUP IS ON | | | | ← PICKUP IS OFF |

